

VERSE TECHNICAL GUIDE

FEBRUARY 2025

Contents.



03. BASE UNITS



08. UNDERCOUNTER APPLIANCES



10. BASE UNITS
Fitting Guide



12. WALL UNITS



14. TALL UNITS
Vertical Double Profile



16. TALL UNITS
Vertical Single Profile



18. VERTICAL RAIL
Fitting Guide



20. VERTICAL RAIL
Appliance Fillers



22. CONTACT

01

BASE UNITS





1. TOP-RAIL

- › Top-rail profile for base units **[NGPTOP**]**
- › Length 4100mm
- › Can be cut to size on site using a circular chop saw.
- › Secure to base units using fixing brackets. Supplied in pairs **[NGPFIxB]**.
- › Base cabinets are supplied routed to accommodate the rail.

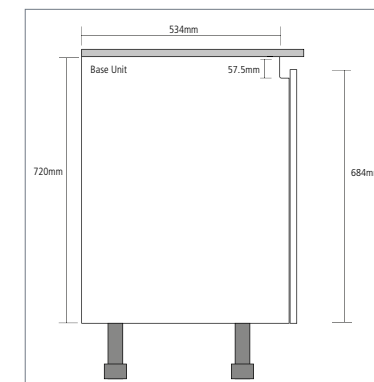

NOTE: Distance behind top-rail to back of carcass is 534mm, units may need to be pulled forward to accommodate sink and/or hob.

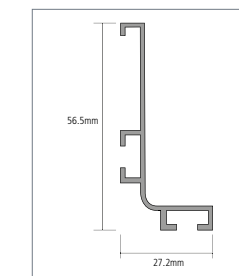

2. TOP-RAIL END CAPS

- › Caps to be used with the top-rail to finish against a wall, end panel or appliance.
- › Supplied in pairs **[NGPTOPCAP**]**
- › Colour co-ordinated to top-rail.

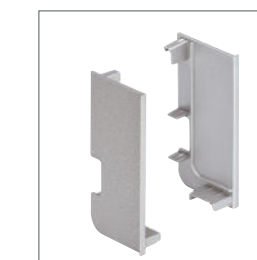

3. TOP-RAIL EXTERNAL CORNER

- › Use with the top-rail when running the rail around corners on the end of a base unit run or on an island.
- › For use in conjunction with external corner posts or mitred island end panels.
- › Supplied singularly **[NGPTOPEXT**]**
- › Colour co-ordinated to the top rail profile.

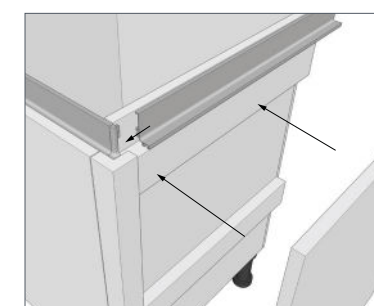

4. TOP-RAIL INTERNAL CORNER

- › Use with the top-rail to run the rail around corner base units [suitable with both conventional and 'L' shape corner bases].
- › Supplied singularly **[NGPTOPINT**]**
- › Colour co-ordinated to the top rail profile.

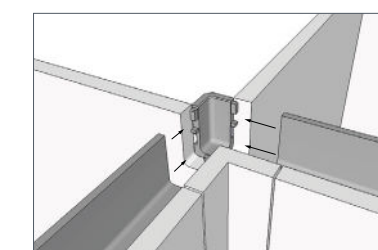

NOTE ** Refers to rail colour.



5. MID-RAIL

- › Mid-rail profile for use with base unit drawer packs **[NGPMID**]**.
- › Length 4100mm
- › Can be cut to size on site using a circular shop saw.
- › Secure to the base units using fixing brackets. Supplied in pairs **[NGPFIXB]**.
- › Base drawer cabinets supplied routed to accommodate the rail.

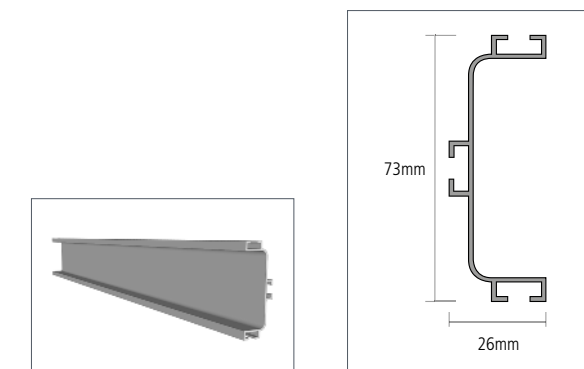

2 X DRAWER BASE

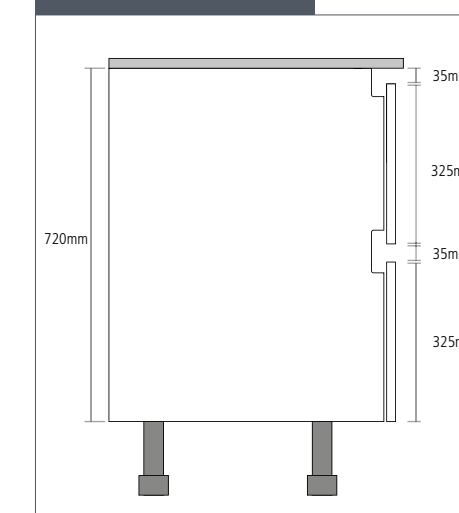

3 X DRAWER BASE

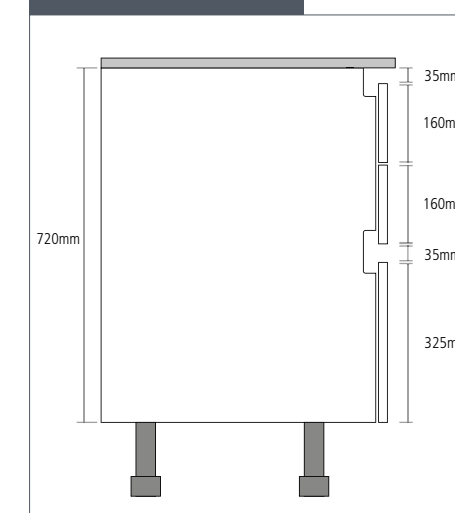

NOTE ** Refers to rail colour.

6. MID-RAIL END CAPS

- › Use with the mid-rail to finish against a wall, end panel, appliance or high-line base unit.
- › Supplied in pairs **[NGPMIDCAP**]**
- › Colour co-ordinated to the mid-rail profile.





Image: Shoreditch Thyme + Mist

SINGLE OVEN HOUSING

- › Top-rail cannot be fitted above a single oven in a base unit, or above a built-under double oven.
- › Use end caps **[NGPTOPCAP**]** to finish the top-rail on either side of the appliance.
- › Use end caps **[NGPMIDCAP**]** to finish the mid-rail on either side of the appliance.



DISHWASHER + REFRIGERATION HOUSING

- › To fit appliances below the top-rail the appliance height must be checked carefully before ordering.
- › The distance below the top-rail to the floor is 812mm.
- › Plinth height can be raised to 155mm in order to accommodate appliances up to 817mm high.
- › When appliances cannot fit below the top-rail [including free-standing appliances] we recommend fitting base panels either side of the appliance and terminating the top-rail on each side.
[Note: a full height 715mm door will need to be ordered when installing in this way].



NOTE ** Refers to rail colour.



Image: Epos Slate

STEP ONE

- › Insert the dowelled fixing bracket **[NGPFIXB]** into the pre-drilled unit side gable and screw into place.

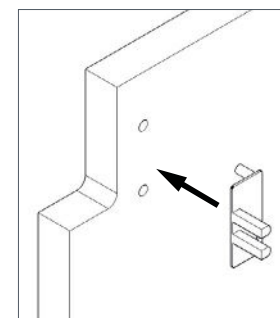

STEP TWO

- › Slide the locking devices onto the rail.

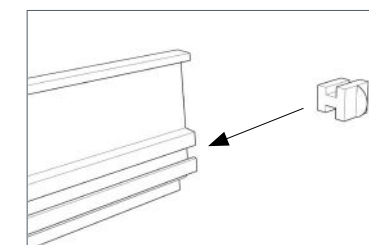

STEP THREE

- › Sit the rail onto the routed gable end and rotate the locking device into the fixing bracket.

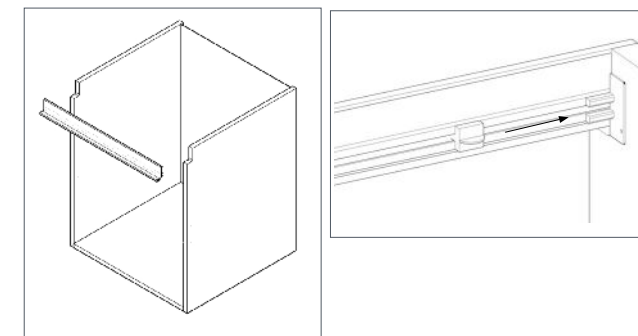

STEP FOUR

- › The rail is now secured in place.

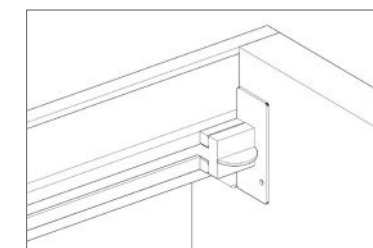

STEP FIVE

- › Fit end caps if required.

NOTE:
1mm spacing must be taken into account when cutting down the rail.

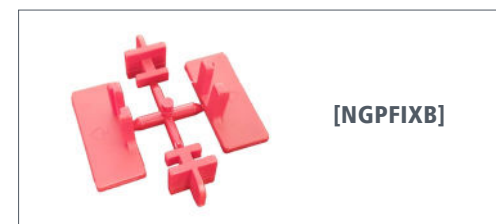
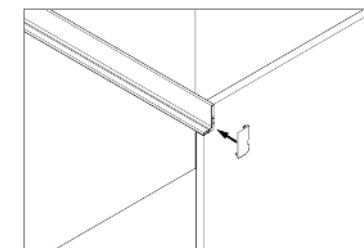

[NGPFIXB]



04

WALL UNITS

Image: Zeta Gloss White + Grey

WALL UNITS

- › Wall profile for all wall units **[NGPWALL**]**
- › Length 3900mm
- › Can be cut to size on site using a circular chop saw.
- › Wall carcasses are supplied routed and notched to accommodate the wall profile.
- › No fixings required – profile slots directly into the carcass [clear silicone adhesive should be used to bind the rail with the panel].
- › Note that wall profiles must be mitred for corner wall units [no internal corner connectors are available for wall profiles].
- › Plant-on end panels must be fitted to all wall unit end runs due to the carcass side gables being notched for the rail.

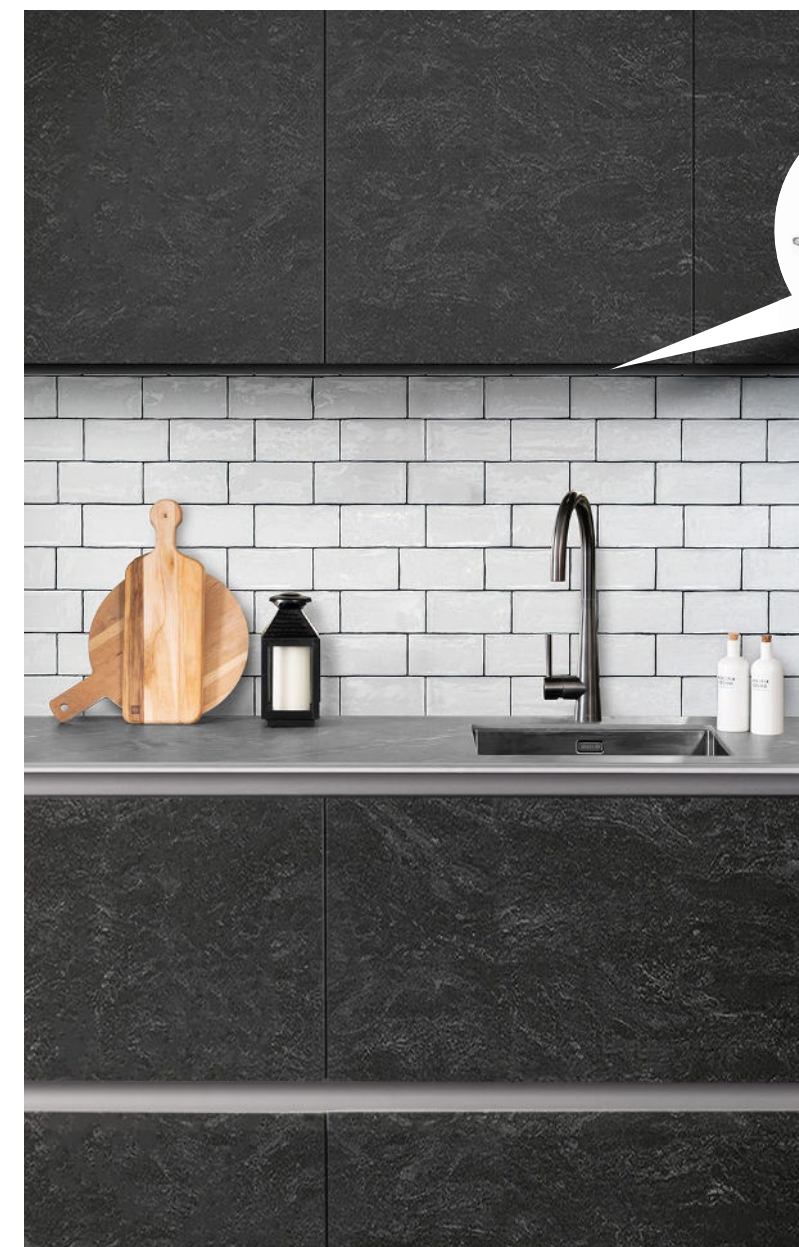

FITTING DETAILS:

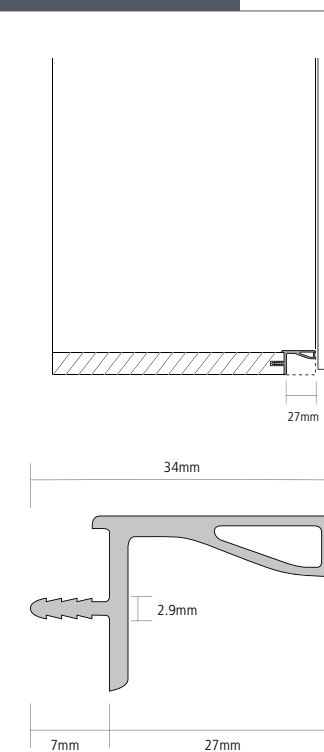

NOTE ** Refers to rail colour.



VERTICAL DOUBLE RAIL PROFILE

- › Vertical double rail profile is used for fitting onto tall units when two opening doors meet.
- › Lengths 2400mm **[NGPVD**]**
- › Can be cut to size on site using a circular chop saw.
- › Secure to the tall units.
- › Tall unit gables are supplied routed to accept the vertical rail.
- › Tall units will then have a 35mm space between each unit to allow for the vertical rail.
- › Specify left-hand hinged [L] or right-hand hinged [R] option when ordering tall units. If a vertical profile is to be fitted on both sides of a tall housing then a double-handed [D] option should be specified [see illustration].

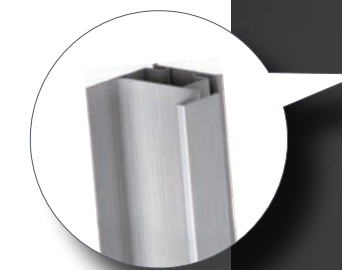

FITTING DETAILS:

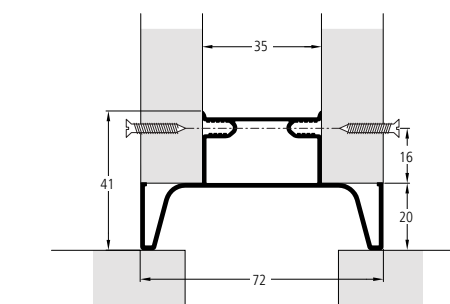
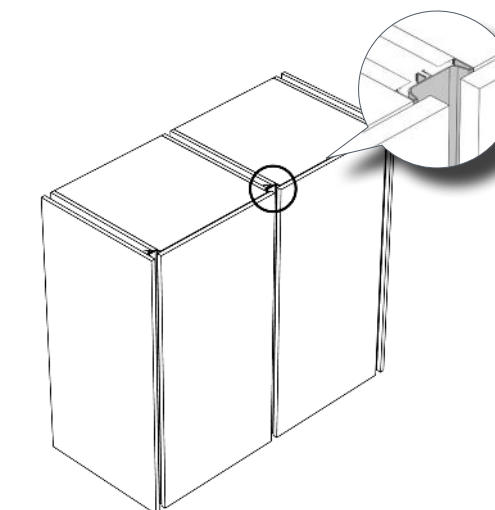

NOTE ** Refers to rail colour.



VERTICAL SINGLE RAIL PROFILE

- › Vertical single rail profile is used for fitting onto tall units when you have an opening door on one side only. It can also be used to end a run when an end panel is fitted.
- › Lengths 2400mm **[NGPVS**]**
- › Can be cut to size on site using a circular chop saw.
- › Secure to the tall units.
- › Tall unit gables are supplied routed to accept the vertical rail.
- › Tall units will then have a 35mm space between each unit or end panel to allow for the vertical rail.
- › Specify left-hand hinged [L] or right-hand hinged [R] option when ordering tall units [see illustration].



FITTING DETAILS:

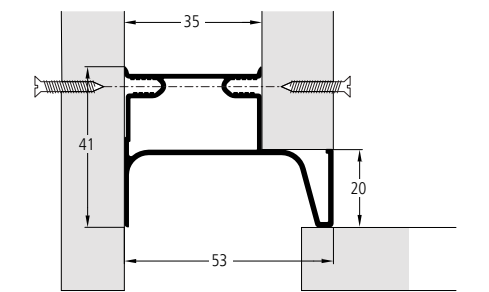
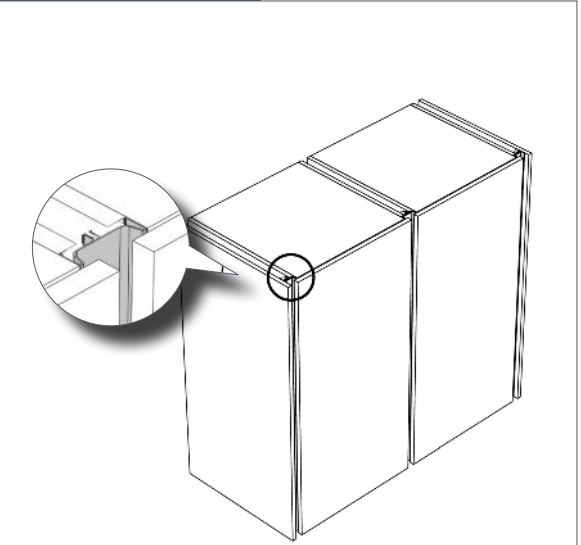

NOTE ** Refers to rail colour.



Image: Brava Rustic Iron + Dark Walnut

VERTICAL SINGLE FIXING BETWEEN CABINET + DOOR

- > **Step 1:** Ensure there is a 35mm gap between the cabinets
- > **Step 2:** Place the profile into position
- > **Step 3:** Secure with Hospa Ø4.5mm screws [not supplied]

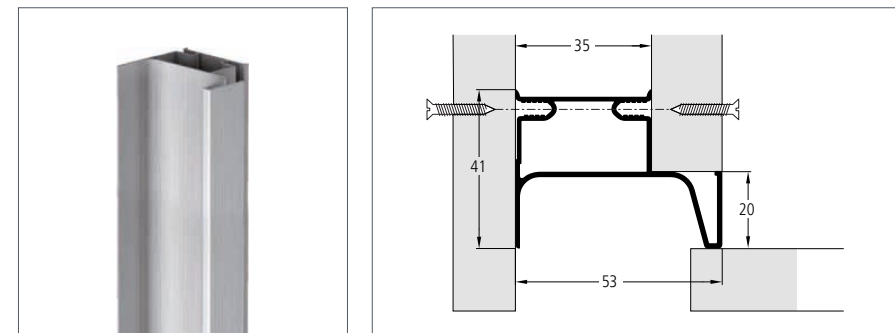

VERTICAL SINGLE FIXING BETWEEN DOORS

- > **Step 1:** Ensure there is a 35mm gap between the cabinets
- > **Step 2:** Place the profile into position
- > **Step 3:** Secure with Hospa Ø4.5mm screws [not supplied]

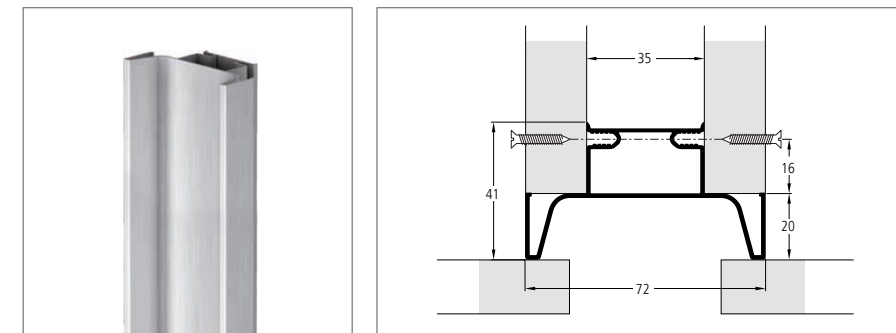



VERTICAL RAIL APPLIANCE FILLERS

- › Fillers for use behind appliances to fill the void in the vertical profile.
- › For appliances less than 600mm, the filler will overhang
- › 580mm single oven filler **[NGPAF580**]**.
- › Colour co-ordinated to the vertical rail profile.

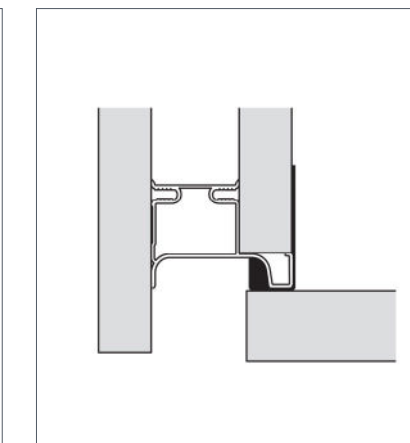
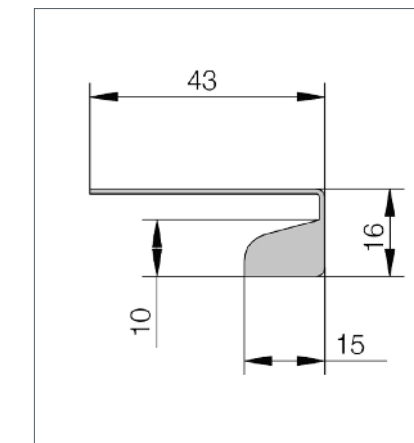

STEP ONE

- › Fix the filler in position with woodscrews.

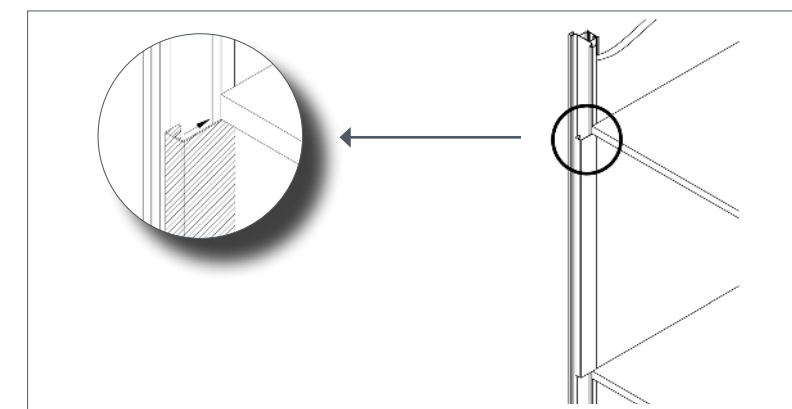

STEP TWO

- › Fit the appliance into place. You may have to drill through the appliance filler if the appliance requires a screw fixing into the cabinet.

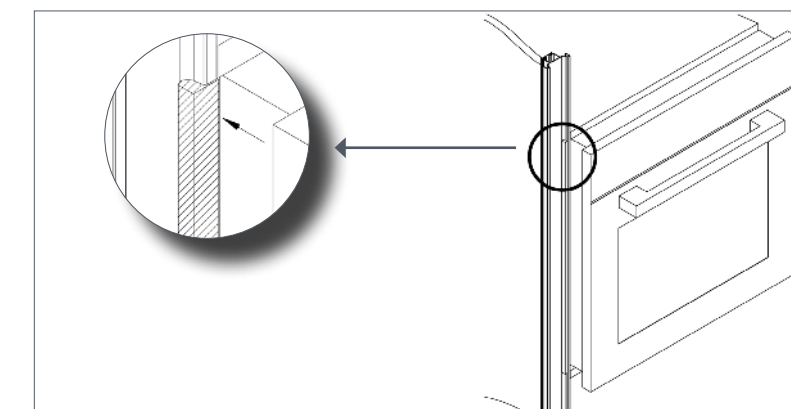

NOTE ** Refers to rail colour.



Fourth Way t: 0117 938 1900
Avonmouth f: 0800 373 163
Bristol e: furniture@caple.co.uk
BS11 8DW w: caple.co.uk



CapleUK



caple



capleuk