

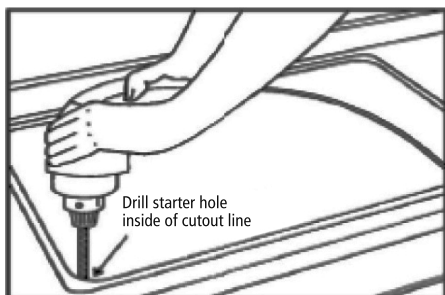

Granite Sink Tap Hole Cut-Out.

STEP 1

Drill a guide hole inside of the cut-out line.



STEP 2

Identify which pre-marked tap hole(s) you will require. Using a hole saw, drill out the tap hole part way from the underside of the sink.

STEP 3

Finish drilling the hole from the upper surface of the sink to ensure a clean edge. It may be necessary to cool the tip of the drill with water to prevent burning, for this reason we recommend the use of a battery powered drill. Take special care if using a mains electric drill around water.

