



## ASPEN



Stainless  
STEEL

### PRODUCT CODE

ASP2/SS

### FINISH AVAILABLE

- Anthracite
- Pebble Grey
- Stainless Steel [shown]

### GENERAL FEATURES

- Single lever ceramic valve
- Single flow
- Single lever design
- Minimum 0.3 bar pressure required

### ↔ DIMENSIONS

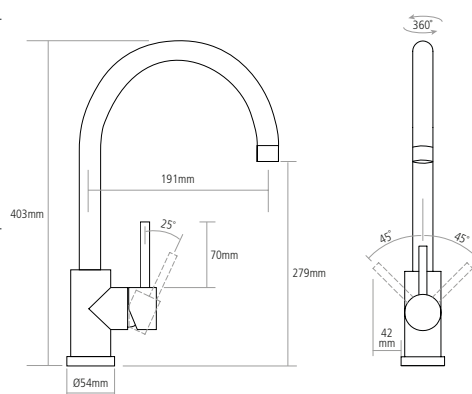

Worktop cut out 35mm required